

## PUMP HEAD KIT 2088 / 2090 PUMPS

### EARLIER VERSIONS:

This kit fits **all** earlier versions of the model 2088. Do not be alarmed if this kit appears physically different than your existing upper housing/switch assembly.

*NOTE: Before starting work, make certain that power to pump is off. Release liquid pressure on the outlet line of pump before performing maintenance. You may find it easier to remove the pump and work on a bench.*

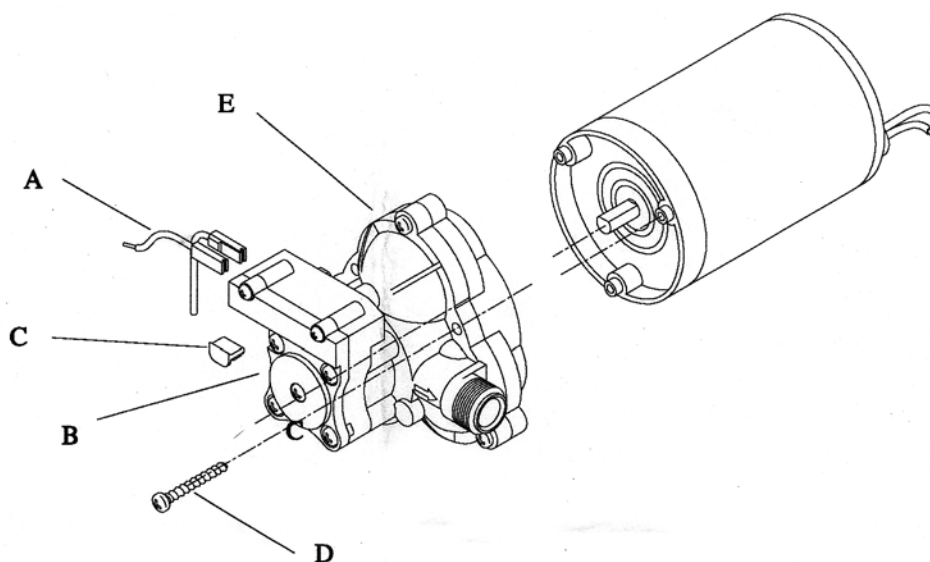

### DISASSEMBLY:

1. Disconnect lead wires (A) from pressure switch (B). Note which wire goes to each lead on the switch.
2. Remove the strain relief plug (C) by pushing out on plug from the motor side with a flat blade screwdriver. Pull the lead wires through the strainer relief.
3. Remove the three long screws (D). These screws hold the pump head assembly to the motor.
4. Remove the pump head (E).

### ASSEMBLY:

1. Place the new pump head (E) on the motor shaft.
2. Put the three long screws (D) in place and screw down until each touches, then tighten each screw securely.
3. Attach the lead wires (A) onto switch.
4. Place the strain relief (C) in original position.



# Liberty

## Ersatzteile & Zubehör

Liberty Vertriebs GmbH  
Bonner Straße 103  
40589 Düsseldorf

Tel.: 0211-753520  
Fax.: 0211-753575

Internet: [www.libertyshop.de](http://www.libertyshop.de)  
Email: [verkauf@libertyshop.de](mailto:verkauf@libertyshop.de)